

# CrossOver X45 Lock Installation

Need another copy of these installation sheets? You can download one at [www.CrossOverLock.com/SupportCenter.htm](http://www.CrossOverLock.com/SupportCenter.htm)

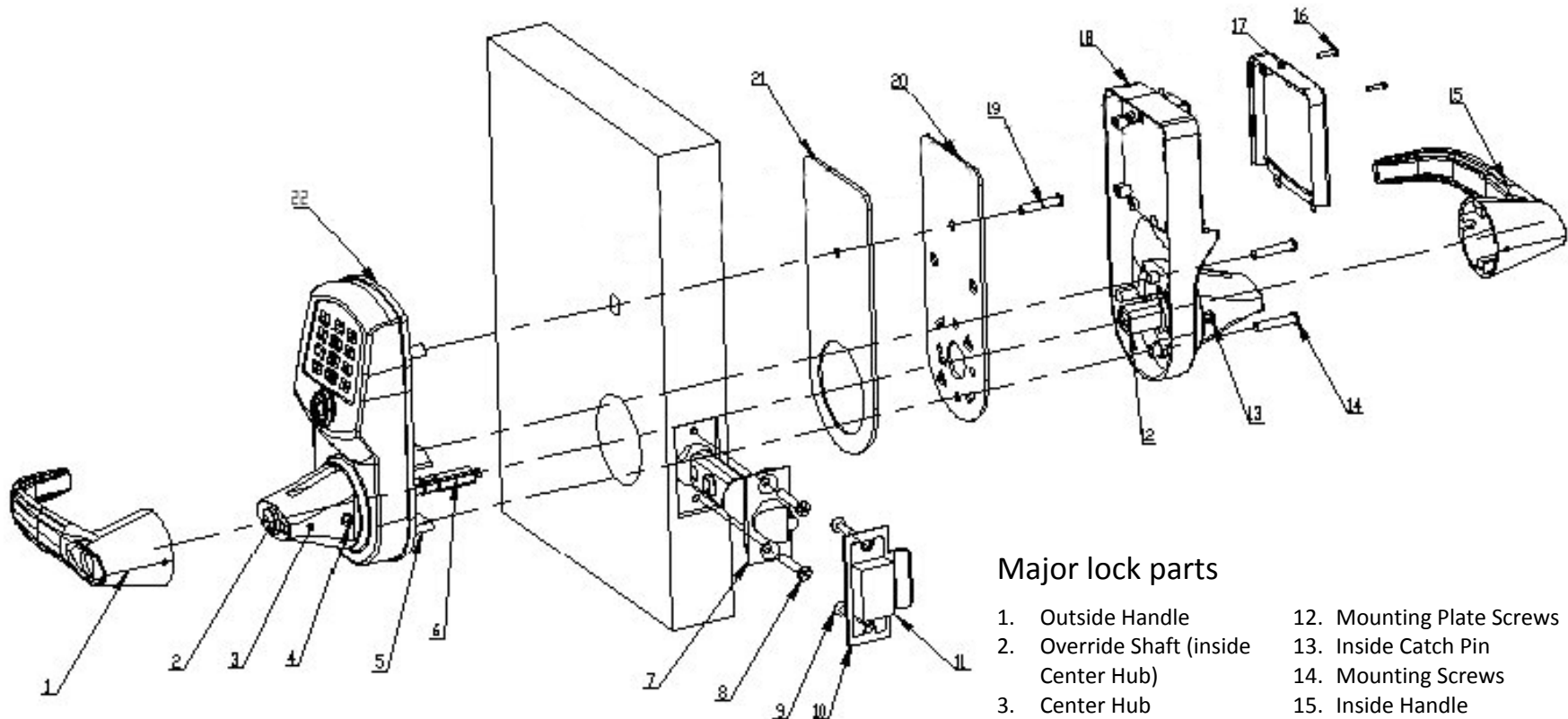

## Major lock parts

- |                                       |                           |
|---------------------------------------|---------------------------|
| 1. Outside Handle                     | 12. Mounting Plate Screws |
| 2. Override Shaft (inside Center Hub) | 13. Inside Catch Pin      |
| 3. Center Hub                         | 14. Mounting Screws       |
| 4. Outside Catch Pin                  | 15. Inside Handle         |
| 5. Outside Lock Housing               | 16. Battery Lid Screws    |
| 6. Square Drive Shaft                 | 17. Battery Lid           |
| 7. Latch                              | 18. Inside Lock Housing   |
| 8. Latch Screws                       | 19. Mounting Plate Screw  |
| 9. Strike Plate Screws                | 20. Mounting Plate        |
| 10. Strike Plate                      | 21. Inside Gasket         |
| 11. Dust Boot                         | 22. Outside Gasket        |

**Step 1: Install the latch**

If necessary, drill holes in door as shown in the accompanying template. Then insert the latch into the hole and attach it with two screws.

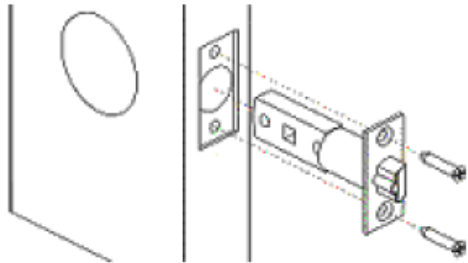
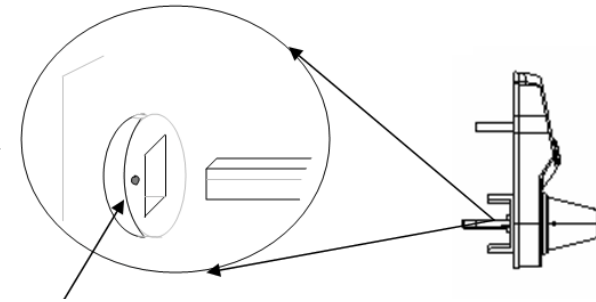

Figure 1

**Step 2: Install the outer half of the lock**

- A. Place the outside gasket – on the back of the outside half of the lock (the half with the keypad) and align the gasket along the edge of the lock.



- B. Insert the slightly larger end (with the hole in it) of the square drive shaft

The dot on the center hub should be pointing to the left.

Make sure that the dot on the center hub is pointing to the left. (Figure 2)

Figure 2

- C. Slide the outside half of the lock into the door, running the drive shaft through the latch and feeding the power cable above or below the latch in the door hole. (Figure 3)

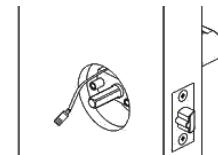

Figure 3

**Step 3: Install the inside mounting plate**

- A. Place the inside gasket on the door and align it with the door hole. Make sure the three nubs on surface of the gasket aren't facing the door.
- B. Feed the power plug through the small rectangular hole in the mounting plate, then position the plate against the gasket and door. The flanges on the mounting plate will fit around the inside of the door hole, and the nubs on the gasket will line up with holes in the plate. Attach the plate to the outside half of the lock with three screws and lock washers.



Figure 4

**Step 4: Install the inside half of the lock**

- A. Plug the power cable into the inside half of the lock, then place the inside half on the mounting plate, making sure that the square drive shaft fits into the center hub of the lock half and that the lock half is securely seated inside the raised edge of the gasket.
- B. Secure the inside lock housing with two screws at the top and bottom of the center hub.
- C. Insert the 4 AA batteries. For now, leave the battery compartment open: You'll need access to the lock's reset button (located below the batteries) when you program the lock.

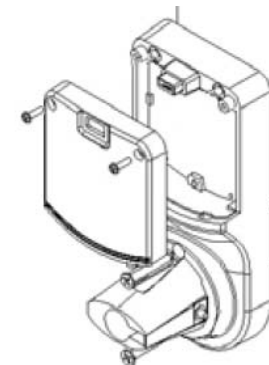

Figure 5

**Step 5: Install the inside handle**

Decide whether the inside handle—the handle without a keyhole—should point to the right or left, and insert it onto the center hub, pressing in the appropriate pin on the side of the center hub so it fits into the hole on the side of the handle.



Figure 6

**Step 6: Install the emergency lock cylinder and the outside handle**

- Make sure the override shaft inside the center hub is in a vertical position. (Figure 7) Use a flat-bladed screwdriver to turn the shaft if necessary.
- Remove the key from the cylinder, then place the cylinder into the outside handle, exposing the cylinder's keyhole in the hole in the handle. Insert the key into the cylinder and turn the cylinder/key assembly so that the flange on the cylinder is pointing to the right and will fit into the slot on the right side of the center hub. (Figure 8)
- If necessary, turn the key clockwise a quarter-turn so that the black tab extending from the back of the cylinder (Figure 8) is vertical, so that it matches the override shaft in Step A.
- Decide whether the handle should point to the right or left (generally, the inside and outside handles point in the same direction). While guiding the cylinder into the cylinder housing, press the handle onto the center hub, depressing the appropriate pin on the side of the hub so it fits into the hole on the side of the handle.
- Turn the key counter-clockwise a quarter-turn and pull the key out.

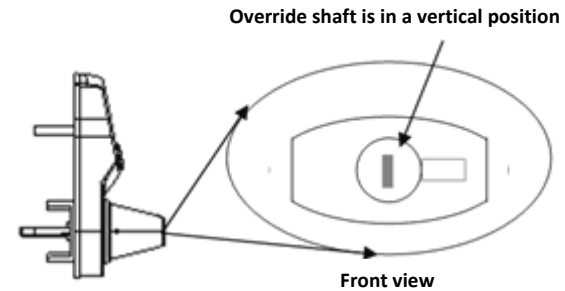

Figure 7

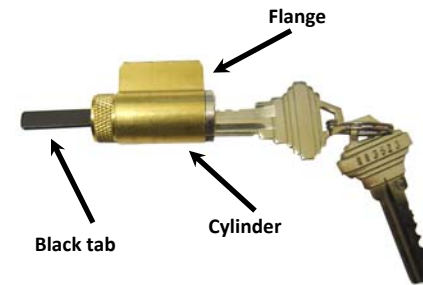
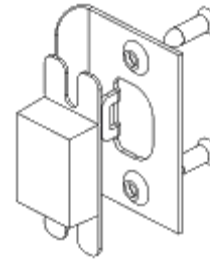

Figure 8

**Step 7: Install the strike plate**

After preparing the door jamb as indicated in the drilling template, insert the dust boot into the doorframe. Then place the strike plate over the dust boot and secure the plate in place with two screws.



The completes the installation of your lock. Please see the AccessPilot software manual for instructions on setting it up.

Notes

# CrossOver X45 door template – 2<sup>3</sup>/<sub>8</sub>-inch backset

(See page 6 for 2 <sup>3</sup>/<sub>4</sub>-inch backset and page 7 for door jamb template)

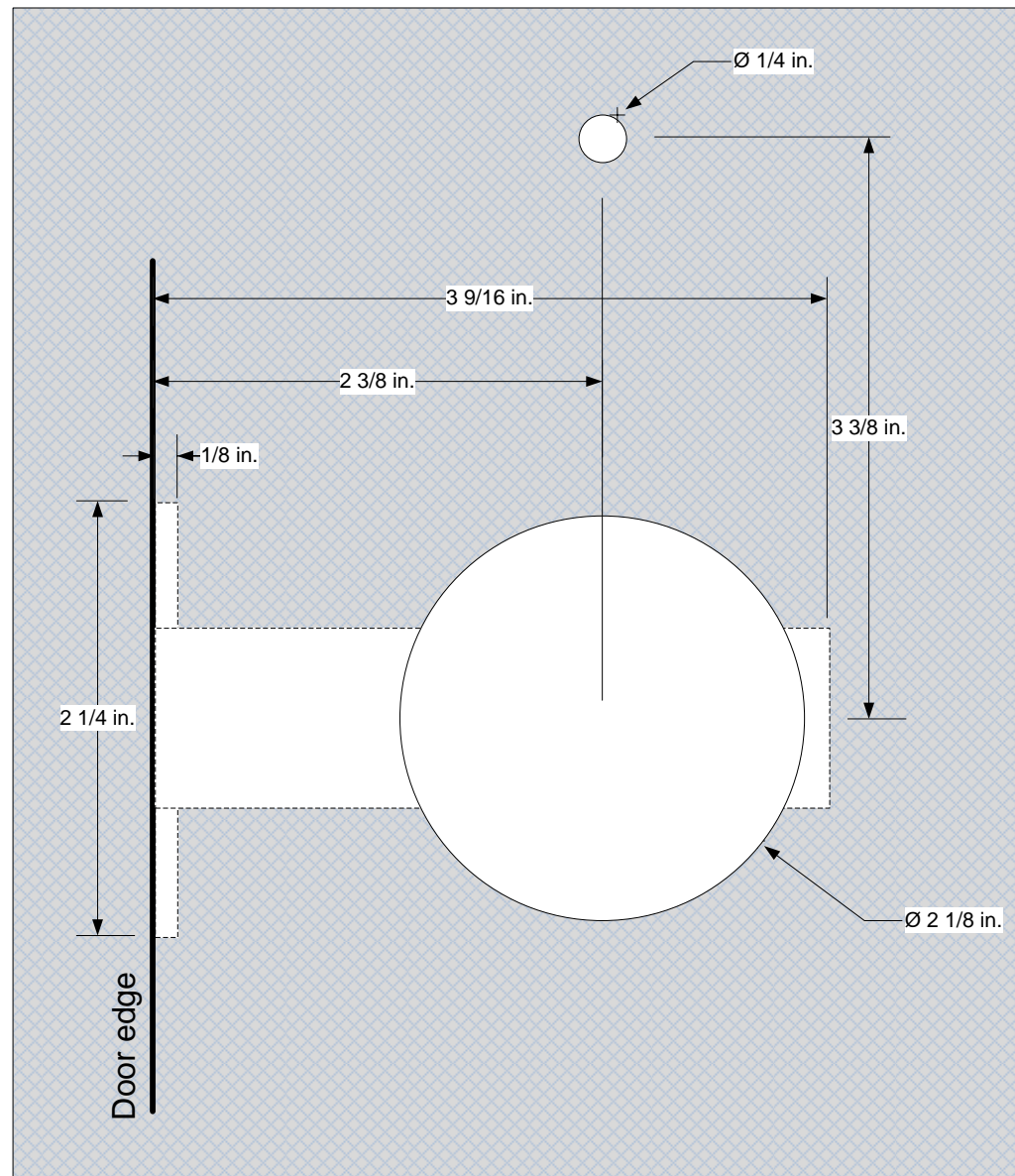
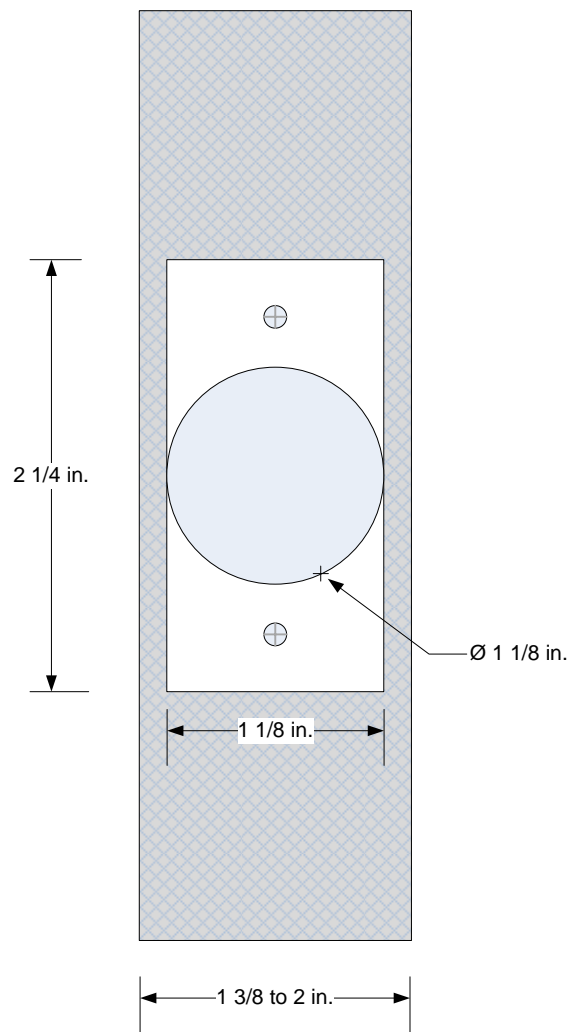

# CrossOver X45 door template – 2¾-inch backset

(See next page for door jamb template)

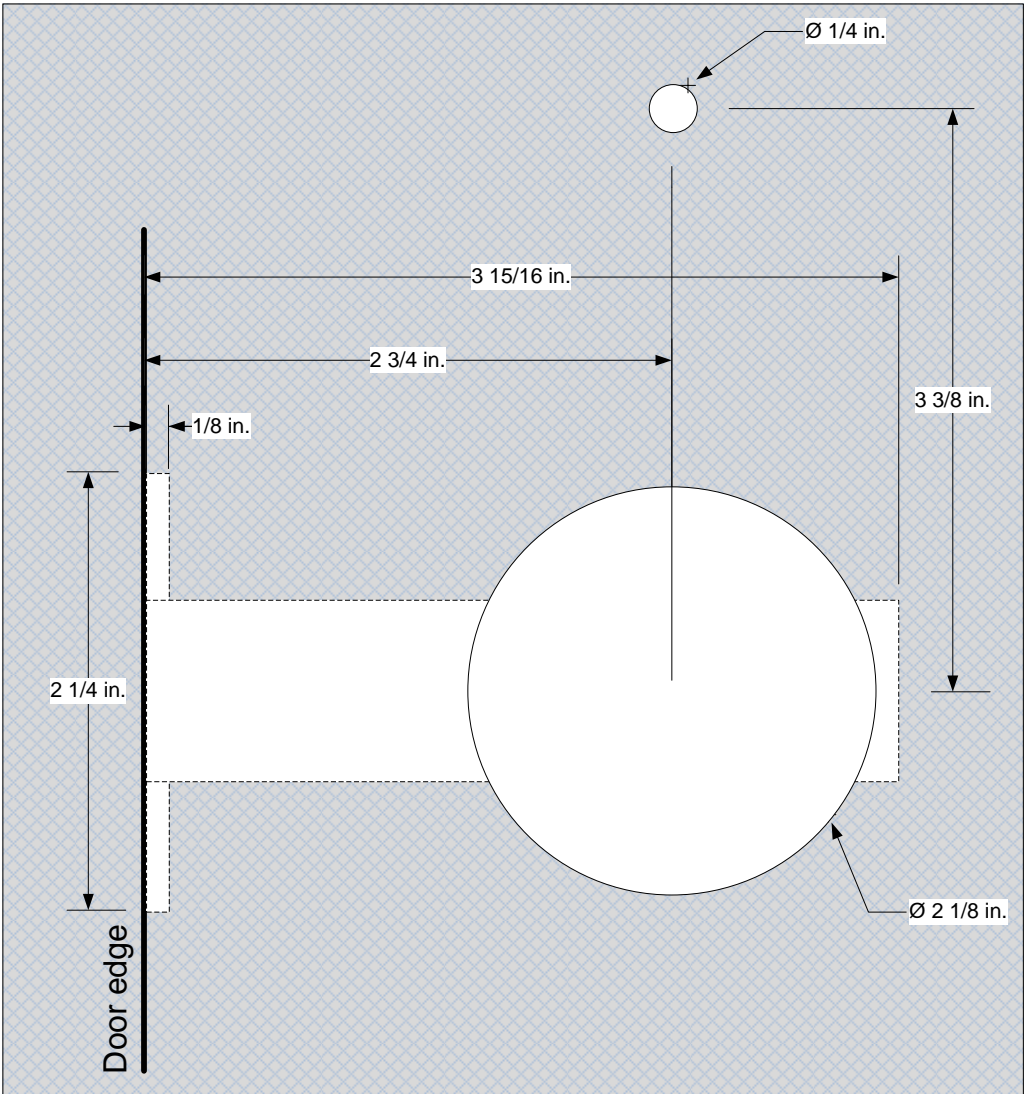
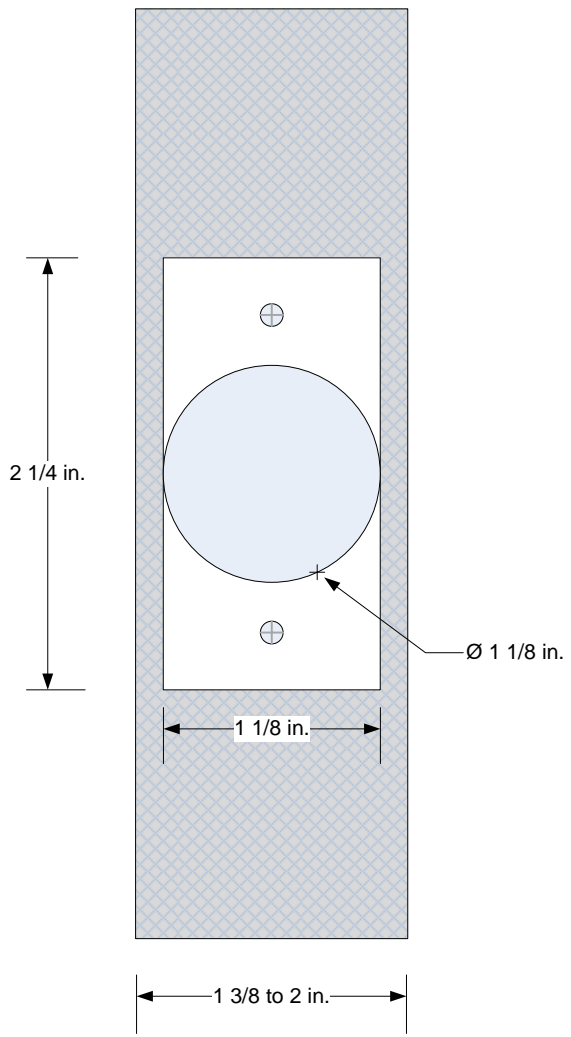

# CrossOver X45 door jamb template

(See pages 5 and 6 for door templates)

